



coban
residences
SECTOR - 99A, GURUGRAM

**PREMIUM LIFESTYLE
AT UN-MATCHED PRICE**



A NEW WAY OF **PREMIUM LIVING**

10.5 ACRES

(42,491.99 sq. m) of Development)

OVER 77%

of Landscaping Space

12,180 SQ.FT.

(1,131.559 sq.m) Clubhouse

The COBAN Residencies is situated in Sector 99A Gurgaon, Dwarka Expressway and the apartments are the perfect combination of premium features and contemporary architecture. It is Close to Clover Leaf that connects SPR, Dwarka Expressway and NH-48. Coban is in close vicinity to Global City and the Indian International Convention Centre which can hold about 10,000 people at a time. You get to choose from 2BHK, 3BHK, and 4BHK properties, and you will also have access to premium amenities, including a gymnasium, swimming pool, car parking lot, and green spaces.



PREMIUM LIFESTYLE AMENITIES



Amphitheatre



Kids Play Area



Terrace Garden



Pond



Gymnasium



Restaurants



Terrace Garden



Cycling Track



Basketball Court

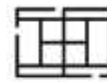

Tennis Court

PREMIUM SPECIFICATIONS

LIVING/DINING ROOM

Flooring: Vitrified Tiles

Wall: Oil Bound Distemper

Ceiling: POP Cornice

Doors: Hardwood Frame & Flush Door Finished with Paint
Main Entrance Door will be Decorative Flush Door.

Windows/Glazing: UPVC/ Hardwood with matching fitting

Electricals: Modular switches, TV and Telephone Socket

KITCHEN

Type: Modular Kitchen

Flooring: Ceramic Tiles

Wall: Ceramic Tiles upto 2' Height above Kitchen Platform

Ceiling: Oil Bound Distemper

Door: Hardwood Frame & Flush Door Finished with Paint

Windows/Glazing: Hardwood/UPVC with matching fitting

Platform: Pre-polished Granite Platform with Stainless Steel Sink

Fittings/Fixtures: CP Fittings; Electricals: Modular switches

BALCONY

Flooring: Ceramic Decorative Tiles

Wall: Semi Permanent Long Lasting Finish

Door: Flush Door/UPVC

Windows/Glazing: Hardwood/UPVC with matching fitting

Electricals: Modular switches

OTHERS

Intercom System

Split A/C in Living, Dining & Bedrooms

MASTER & OTHER BED ROOMS

Flooring (Master Bedroom): Laminated Wooden

Flooring (Other Bedrooms): Vitrified Tiles

Wall: Oil Bound Distemper

Ceiling: POP Cornice

Door: Hardwood Frame & Flush Door Finished with Paint

Windows/Glazing: Hardwood/UPVC with matching fitting

Electricals: Modular switches, TV and Telephone Socket

TOILETS

Flooring: Ceramic Tiles

Wall: Ceramic Tiles upto 7' Height

Ceiling: Oil Bound Distemper

Door: Hardwood Frame & Flush Door Finished with Paint

Windows/Glazing: Hardwood/UPVC with matching fitting

Sanitaryware/CP Fittings: CP Fittings, European Style with branded

Chrome Plated Brass Fittings (white/colour)

Electricals: Modular switches

SERVANT ROOM

Flooring: Ceramic Tiles

Wall and Ceiling: Oil Bound Distemper

Door: Hardwood Frame & Flush Door Finished with Paint

Windows/Glazing: Hardwood/UPVC with matching fitting

Sanitaryware/CP Fittings: CP Fittings, European Style

Electricals: Modular switches, TV and Telephone Sockets

Toilet: Ceramic Tiles Flooring, CP Fittings

2 BHK + STUDY APARTMENT LAYOUT



SUPER AREA

1,550 Square Feet (144.0 Square Meter)

RERA CARPET AREA

916 Square Feet (85.09 Square Meter)

EXCLUSIVE AREA

1,131 Square Feet (105.07 Square Meter)

3 BHK + SERVANT APARTMENT LAYOUT



SUPER AREA

1,997 Square Feet (185.52 Square Meter)

RERA CARPET AREA

1,220 Square Feet (113.34 Square Meter)

EXCLUSIVE AREA

1,531 Square Feet (142.42 Square Meter)

4 BHK + SERVANT APARTMENT LAYOUT

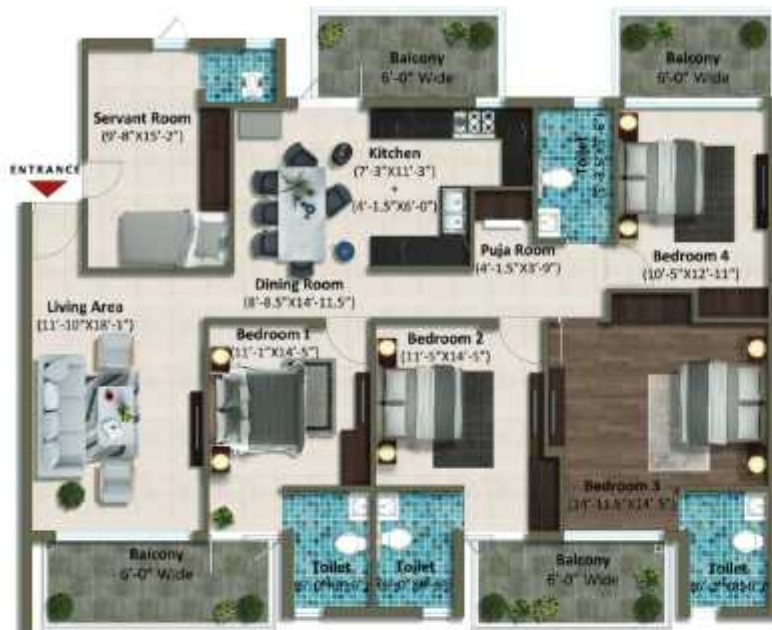

SUPER AREA

2,352 Square Feet (218.50 Square Meter)

RERA CARPET AREA

1,465 Square Feet (136.10 Square Meter)

EXCLUSIVE AREA

1,776 Square Feet (164.99 Square Meter)

COBAN RESIDENCES SITE MAP



1. Tower A
2. Tower C
3. Tower D
4. Tower E
5. Tower B
6. Tower F
7. Tower F
8. Club
9. Pond
10. Amphitheatre
11. Swimming Pool
12. Gazebo
13. Flower bed
14. Jet fountain
15. Children play area
16. E.W.S
17. Nursery school
18. Floor fountain
19. Main entrance
20. Other entry gate
21. Glass & Wooden pergola
22. Basketball court
23. Lawn tennis
24. Badminton court
25. Shopping complex
26. Cafe
27. Jogging track
28. Maze garden



Pareena infrastructures Pvt Ltd



PROPOSED DEVELOPMENT TYPE (as per Master Plan 2031)

- COMMERCIAL
- INSTITUTIONAL (College)
- HOSPITAL
- ISST
- INSTITUTIONAL (School)



Visit: Coban Residences
Sector 99A, Gurugram, Haryana
www.pareena.in | Timing- 10:00a.m-6:30p.m

HARERA GURUGRAM WITH REGISTRATION NUMBER: HRERA-RC/REP/HARERA/GGM/419/151/2020/35

Coban Residences has been registered via HARERA with registration number RC/REP/HARERA/GGM/419/151/2020/35 and is available on the website <http://harera.in/> under registered projects. | The License No. 10 of 2013 issued in name of Monex Infrastructure Pvt Ltd. Further Town & Country Planning Department Haryana has granted permission vide Endst. No. LC- 2753/Asstt(AK)/2020/16642 dated 18-09-2020, issued qua Joint Development rights Marketing Rights in favour of company for 10.5875 acres in respect of Group Housing Colony under license no.10 of 2013 dated 12.03.2013 for 10.5875 acres. | Building Plan Approval vide Memo No. ZP-882/SD(BS)/2013/47004 dated 25.07.2013. Coban Residences is Group Housing Colony in Sector 99A, Gurugram, Haryana, India and is being developed by Pareena Infrastructures Pvt. Ltd. on land admeasuring 4.28461 hectares (ha) (10.5875 acres) owned by M/s Monex Infrastructure Pvt Ltd. ("Company"). Coban Residences consists of 544 no. of residential units/apartments, 96 no. EWS units, convenience shopping and community center./club. This advertisement contains artistic impressions and no warranty is expressly or impliedly given that the completed development will comply in any degree with such artist's impression as depicted. The furniture, accessories, items, goods, additional fittings/fixtures, decorative items including finishing materials, specifications, shades, sizes and colour of the files, etc. shown in the image are only indicative in nature and are only for the purpose of illustrating/indicating a conceived layout and do not form part of the standard specifications/amenities/services to be provided. All plans and images shown in the advertisement is indicative and are subject to changes at the discretion of the Company or competent authorities. The Company shall not assume any responsibility of information provided by third parties and reliance shall be placed only on the information provided on the Company's official website i.e. www.pareena.in. The project land has been mortgaged to M/s Catalyst Trusteeship Limited, Debenture Trustee, appointed to secure Non-convertible Debentures (NCDs) issued by developer and NOC will be provided, if required, for sale, transfer and conveyance of the apartments/units to be constructed on the project land. Please note that some of the infographics and stock pictures used in this presentation have been obtained from publicly accessible web sources. The infographics and pictures are for reference purposes only and not meant for any commercial gain/purposes. The Company has not infringed any third party intellectual property rights and it will not be liable if the user of this presentation misuses the pictures and infographics in any manner.

IMAGES ARE FOR ILLUSTRATIVE PURPOSE ONLY

RC/REP/HARERA/GGM/419/151/2020/35